



Oakio Plastic Wood Building Materials Co.,Ltd.

35th floor, Building 3, Huamao Building, No.11
Wenchang 1st Road, Huizhou, Guangdong, China
Tel: +86 (752) 2222-845
Web: www.oakio.com
Email: info@oakio.com

FIND US ON



For more information, visit www.oakio.com



DESIGNED FOR LIVING **BUILT TO LAST**

Manufacturer of Eco-Friendly Wood Plastic Composites Product



WOOD PLASTIC COMPOSITE

Table of Contents

Discover More

01-04 Who We Are

Products

05-10 Iniwood Cladding
11-16 Proshield Cladding
17-18 Fixing Methods

WHO WE ARE

Designed for living Built to last

Oakio® WPC products have the look and feel of traditional wood, with the added strength, durability and sustainability of a composite material

We Know WPC !

Oakio® WPC is backed by 15-year limited residential warranty on Iniwood Collection and 25-year limited residential warranty on Proshield, Matshield and Elashield Collection. That is how we fulfill our mission of delivering products to help you create the most enduring, durable and enjoyable outdoor living spaces. We are also proud of our continuous conservation and sustainability efforts. Oakio® WPC is made from up to 95 percent recycled materials, saving tens of thousands of trees each year. Oakio® is the industry leader in high-performance wood plastic composite building materials.



Proshield Collection



Iniwood Collection



Designed in USA



Made in China



Environmental Philosophy

Oakio® has always been at the forefront of the green building industry and since our inception in 2009, we have been consistently improving our commitments to the environment.



FSC

Forest Stewardship Council - FSC certification ensures that products come from responsibly managed forests that provide environmental, social and economic benefits. FSC products are optional, standard products are not made by FSC.



LEED

Qualified for LEED Points, up to 95% of the raw materials used to manufacture Oakio® products are sourced within 300 km of our manufacturing facility.



REACH

Oakio® products are all REACH certified which indicates conformity with health, safety and environmental protection standards for products sold within the European Economic Area.



ISO

Our ISO9001 and ISO14001 certification guarantees that our clients get only the best products and service and that the quality of what we offer is constantly and consistently improved.



CE

Oakio® products are all CE certified which indicates conformity with health, safety, and environmental protection standards for products sold within the European Economic Area.

WHO WE ARE

Let's build to last

Craft your WPC products as beautiful and lasting as the memories you'll create on it.

Board-To-Board Colour Variations and touch different

At Oakio® we go to extensive lengths to make our products reflect all of the beauty and nuance of nature. Some of our collections include solid colours while others bear subtle to more pronounced highlights to closely resemble the characteristics of real wood.

Iniwood Collection

The first generation of wood plastic composite (WPC) products. The result is a dense, heavy, and weather resistant products that won't splinter, warp, rot, or split. High quality hard wood fiber (Oak wood) and high density PE resin are the main raw material. Iniwood comes with solid colour, and apart from that, we create 3D embossing wood grain, which makes the colour variegated as well.

Proshield Collection

This is the second generation of WPC products. Designed to reflect the true tones of natural wood, this is our most uniquely variegated line which includes cascading colours. The artisanal, hand-scraped texture has a refined appearance matched with the most advanced design technology available.

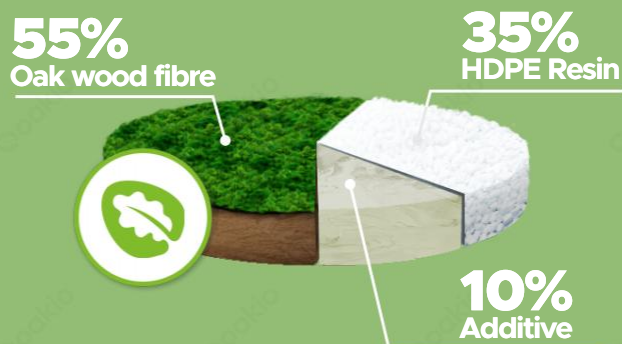

Qualifying for FSC

Iniwood Cladding Collection

Oakio® Iniwood scallop cladding in plateau colour.



Iniwood Cladding

Iniwood is crafted from a durable wood-plastic composite that withstands harsh weather and everyday wear. Its solid construction provides a sturdy, secure feel underfoot. It consists of 55% oak wood fiber, 35% resin, and 10% additives.

- No sealing, staining, or painting required
- Resistant to weather, fading, and warping
- No need for frequent repairs or replacement
- Splinter-free and crack-resistant
- Outperform wood alternatives
- 15-year residential warranty

Profile Choices



IPC01

Size: 140x20 mm
Joist span: 350mm



IPC02

Size: 174x21 mm
Joist span: 350 mm



IPC04

Size: 156x21 mm
Joist span: 350 mm

Add-in Options

The profiles, colours, and textures shown above are our standard options. Oakio also offers full customization, contact us for more at www.oakio.com.

Iniwood Cladding Colour Options

These wood plastic composite collections combine beauty and function. What kind of finish and colour do you like?

Colour Choices

Solid Colour: A Single Colour Without Discrete Markings



Glacier
Code: IC01



Dune
Code: IC02



Cliff
Code: IC03



Mist
Code: IC04



Canyon
Code: IC05



Plateau
Code: IC06

Variegated Colour: Discrete Markings Of Different Colours

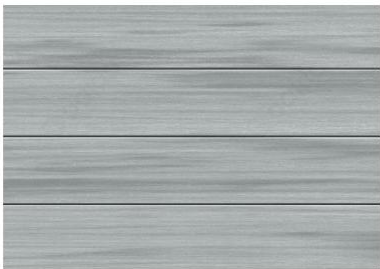

Smoke White
Code: ICV01



Sunglow
Code: ICV05



Lava
Code: ICV09

Magnificently Durable Iniwood Textures

Iniwood features a range of wood grain finishes that mimic the look and feel of exotic hardwoods. Easy to clean, low-maintenance, and built with advanced moisture and fade resistance for long-lasting durability.

Texture Options



Code: IW01 | Sanding surface | 942mm Repeat



Code: IW02 | Light Embossing | 942mm Repeat



Code: IWV01 | 3D Embossing | 942mm Repeat



Code: IWV02 | 3D Embossing | 942mm Repeat



Code: IWW03 | 3D Embossing | 942mm Repeat



Code: IWW04 | 3D Embossing | 1256mm Repeat

Add-in Options

The profiles, colours, and textures shown above are our standard options. Oakio also offers full customization, contact us for more at www.oakio.com.

Proshield Cladding

Oakio® Proshieldscallop cladding in westminster colour



Proshield Cladding

Proshield Collection is the second generation of Iniwood Collection with Iniwood materials (35% plastic resin, 55% oak wood fiber and 10% additive) as the core and golf ball material as the shield.

This means that it has an advanced premium shield encasing on all four sides around its inner core. Unlike most of the co-extrusion cladding on the market, Proshield cladding is capped by golf material instead of only PE.

- All the advantages of Iniwood and more
- A variety of unique variegated Colours and wood grain finishes
- Ultra-durable performance
- Resists stains, fading, mold, and mildew
- Enhanced scratch resistance
- 25-year residential warranty

Profile Choices



PPC01

Size: 140x12 mm
Joist span: 350 mm



PPC02

Size: 156x21 mm
Joist span: 350 mm



PPC10

Size: 176x26 mm
Joist span: 350 mm

Add-in Options

The profiles, colours, and textures shown above are our standard options. Oakio also offers full customization, contact us for more at www.oakio.com.

Proshield Colour and Finish Options

These beautifully natural textures offer effortless cleaning and require minimal maintenance, while being built with advanced moisture and fade resistance for long-lasting durability.

Colour Choices



Parthenon

Code: PC01



Angkor

Code: PC02



Petra

Code: PC03



Westminster

Code: PC04



Black Beach

Code: PC05

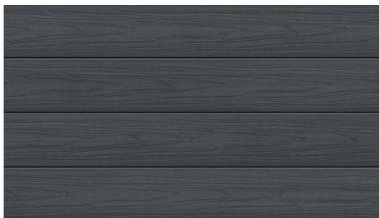

Chichen Itza

Code: PC06



Taj Mahal

Code: PC07



Lake Baikal

Code: PC08



Colosseum

Code: PC09



Pyramids

Code: PC10



Potala Palace

Code: PC12



Casa Batllo

Code: PC20

Magnificently Durable Proshield Textures

Proshield features a range of wood grain finishes that mimic the look and feel of exotic hardwoods. Easy to clean, low-maintenance, and built with advanced moisture and fade resistance for long-lasting beauty.

Plus, built-in antimicrobial protection keeps every surface hygienic and germ-resistant, perfect for wall panels that demand both style and durability.

Texture Options



Code: PW01 | Sanding surface | 942mm Repeat



Code: PW03 | 3D Embossing | 942mm Repeat



Code: PW04 | 3D Embossing | 942mm Repeat



Code: PW05 | 3D Embossing | 942mm Repeat



Code: PW06 | 3D Embossing | 942mm Repeat



Code: PW07 | 3D Embossing | 942mm Repeat



Code: PW09 | 3D Embossing | 942mm Repeat



Code: PW10 | 3D Embossing | 942mm Repeat



Oakio® Iniwood scallop cladding in glacier colour

Fixing Methods

Clips and screws are the main accessories for cladding.
Visit **www.oakio.com** for further information.

Fixing Methods



Code: AM04

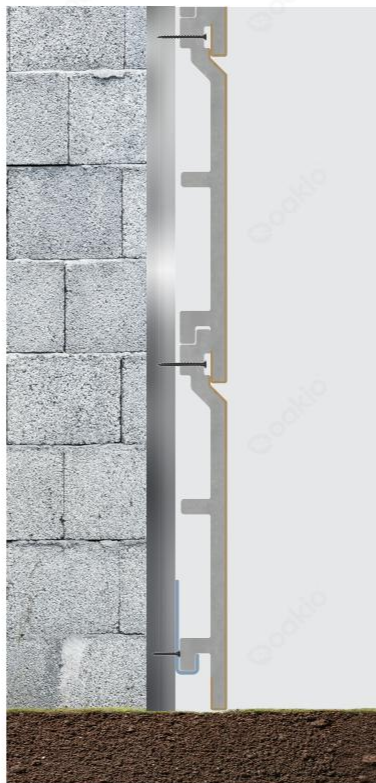

Code: AS04

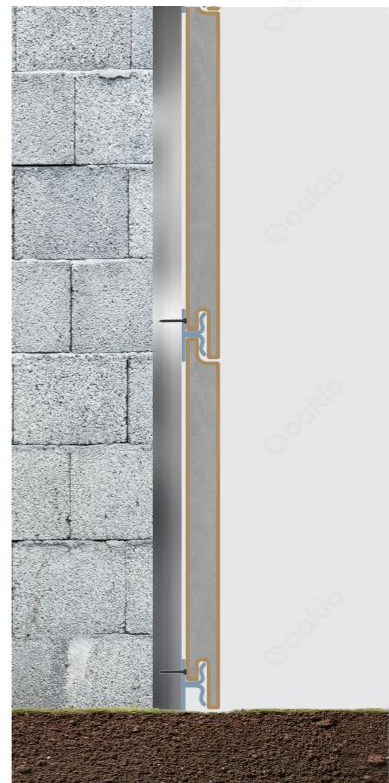

Code: AS13